

Rubber Trails & Surfaces Canada Ltd.

www.rubbertrailsandsurfaces.ca

815 HWY 336
Upper Musquodoboit
Nova Scotia Canada B0N 2M0
Tel.: (902) 568-2469
Fax: (902) 568-2460
info@rubbertrailsandsurfaces.ca

Rubber Flex L Curbs

With a 3 Year material warranty, our Rubber Flex L Curb is designed specifically for artificial turf fields and is made from 100% recycled rubber. This Safety Curbing is easily installed and is available in a 4 inch and 6 inch high profile. Remains flexible in all weather conditions.

It can be painted with a protective UV coating and can be embossed with your field or university name. If you want to reduce the chance of injury and provide better safety for your athletes, stop using traditional edging such as concrete or wood. Protect them and protect yourself with our Rubber Flex Curbs.

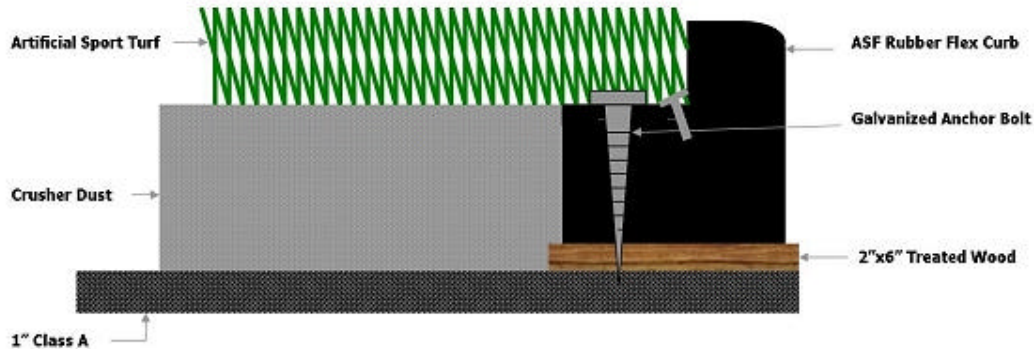

- A. 2"x6" Treated Wood is anchored into the ground or cement base
- B. 5 or 6 Galvanized Lag Bolts with washers are used to secure each Rubber Curb to the Treated Wood Base
- C. Crusher Dust is compacted up to the ledge that secures Artificial Sport Turf
- D. Turf is ram set or screwed into the Rubber Curb
- E. Binder and fine rubber is used to make a paste that bonds the ends of curbs together

**Small Artificial Sport Field
(ASF Rubber Flex Curb)**

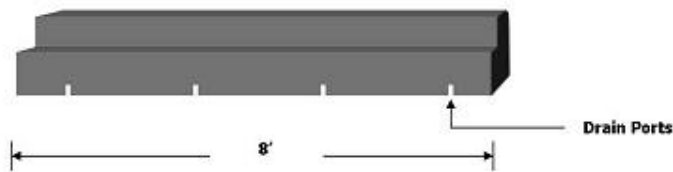
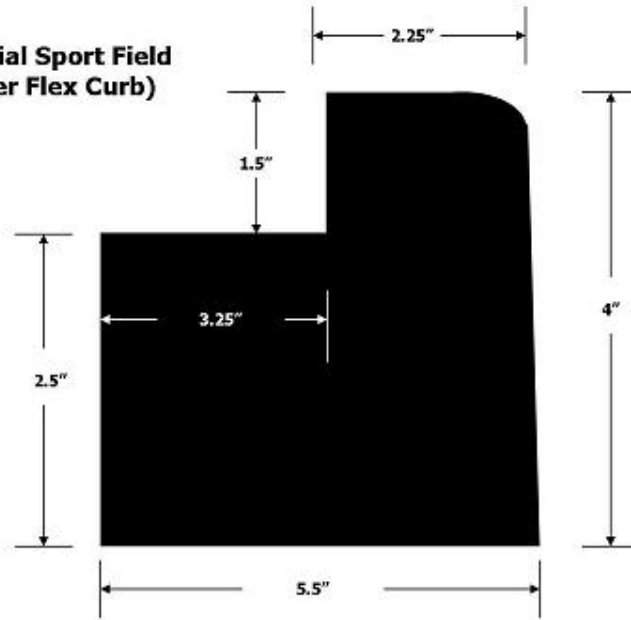

Water Drain Ports are spaced 2' apart and begin 1' from each end of the curb.

**Large Artificial Sport Field
(ASF Rubber Flex Curb)**
*Water Drain Ports are the same as the smaller curb

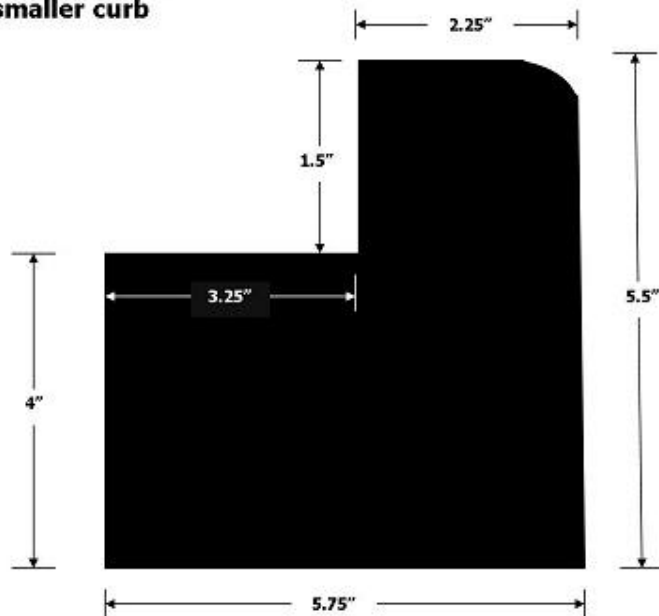

SMALL ARTIFICIAL SPORT FIELD (ASF RUBBER FLEX CURB)

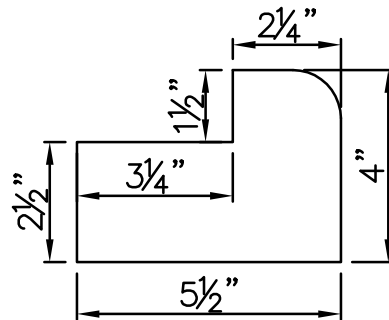

END PROFILE

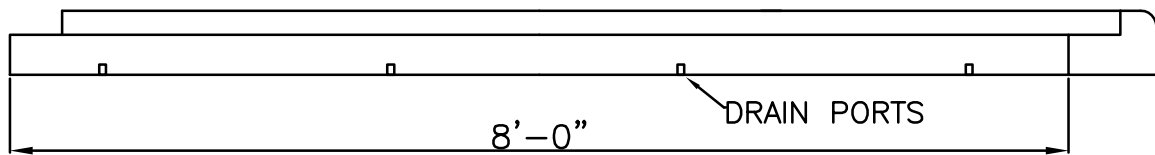

WATER DRAIN PORTS ARE SPACED 2'-0" APART
AND BEGIN 1'-0" FROM EACH END OF THE CURB

SIDE VIEW

RTS Canada Ltd.
Rubber Trails & Surfaces Canada Ltd.
815 Hwy 336 Upper Musquodoboit
Nova Scotia Canada B0N 2M0
Tel: (902) 568-2469
email steve.benison@ns.sympatico.ca

LARGE ARTIFICIAL SPORT FIELD (ASF RUBBER FLEX CURB)

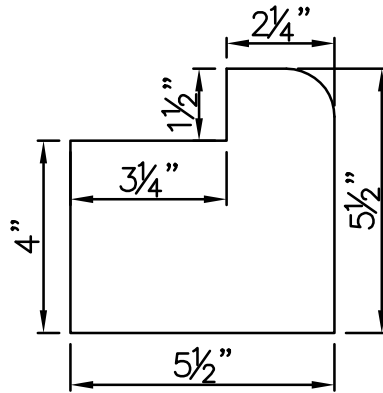

*WATER DRAIN PORTS ARE THE SAME AS THE SMALLER CURB

END PROFILE

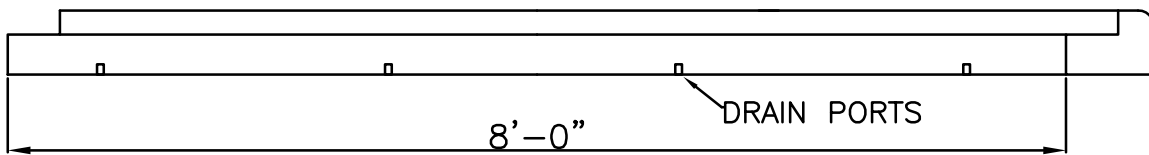

WATER DRAIN PORTS ARE SPACED 2'-0" APART
AND BEGIN 1'-0" FROM EACH END OF THE CURB

SIDE VIEW

RTS Canada Ltd.
Rubber Trails & Surfaces Canada Ltd.
815 Hwy 336 Upper Musquodoboit
Nova Scotia Canada B0N 2M0
Tel: (902) 568-2469
email steve.benison@ns.sympatico.ca

Rubber Flex L Curbs with Built in Drainage Trench

This product was engineered to provide better water drainage for rubber running track and artificial turf combinations.

Each 8' length contains a water port, which delivers excess water from the track surface directly into the drainage system under the artificial turf fabric. This greatly reduces the amount of water that would otherwise have to drain through the artificial turf infill (rubber/sand) as well as the fabric backing.

The trench grating is made of 1/8 inch thick slotted aluminum, providing a strong, good looking and long lasting cover for many years.

The aluminum grate is securely fastened with stainless steel screws and can easily be removed to allow for full access to the drain ports.

Why use concrete when our Rubber Flex Curb will provide you with both the safety and drainage your project requires.



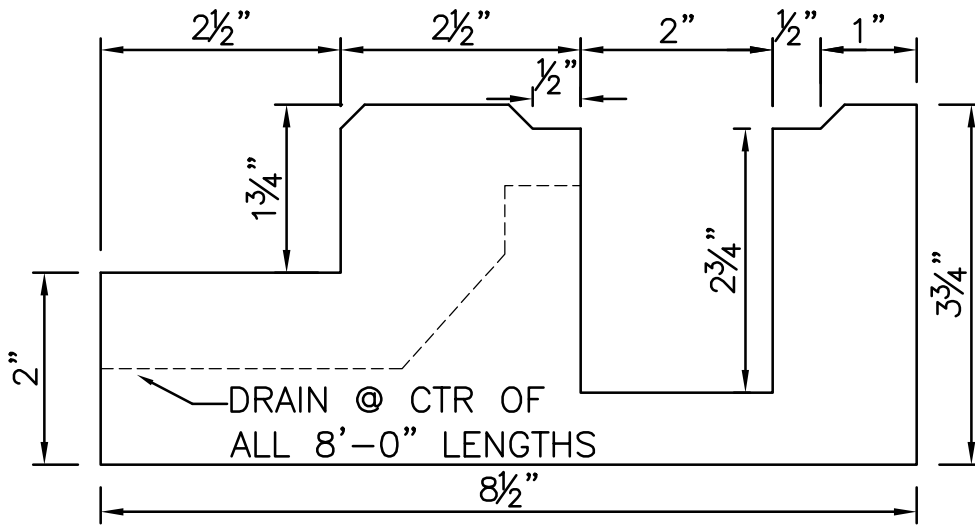

8FT LONG, 5" WATER PASSAGE OPENING IN CENTER OF CURB, SLOTTED ALUMINUM GRATING 1/8"x3"
END PROFILE

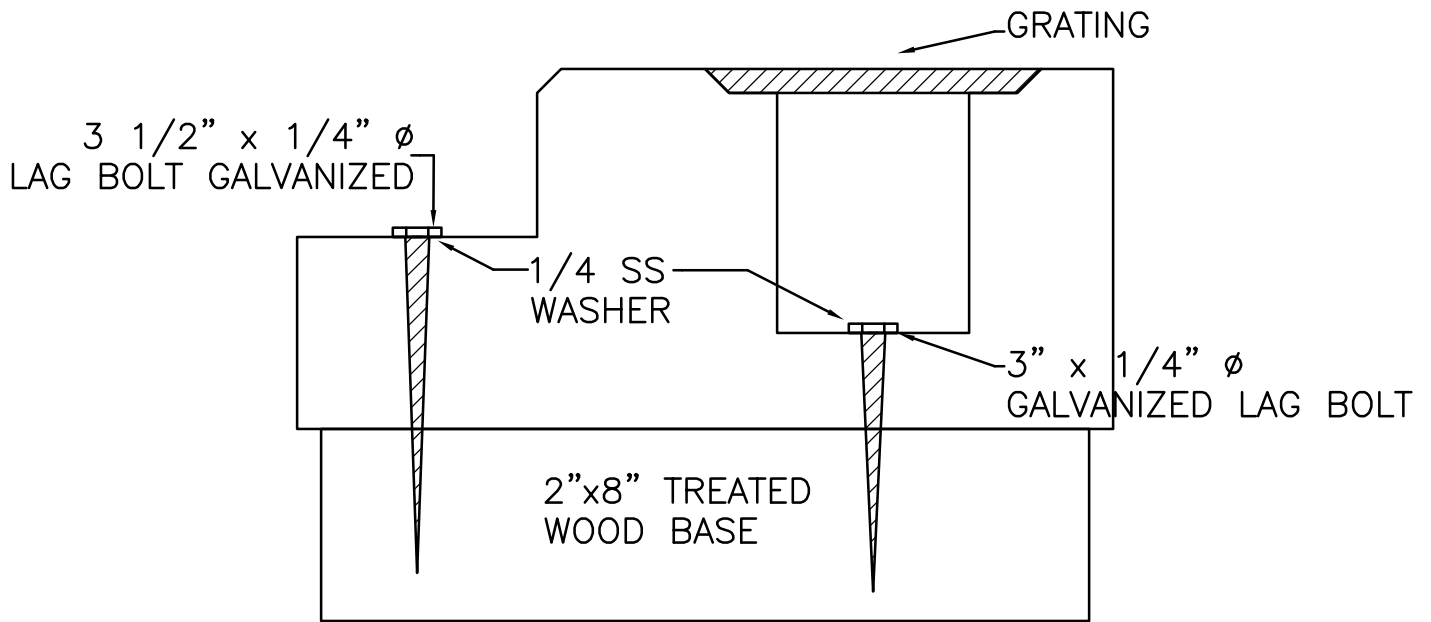

ANCHOR DETAIL

RTS Canada Ltd.
 Rubber Trails & Surfaces Canada Ltd.
 815 Hwy 336 Upper Musquodoboit
 Nova Scotia Canada B0N 2M0
 Tel: (902) 568-2469
 email steve.benison@ns.sympatico.ca

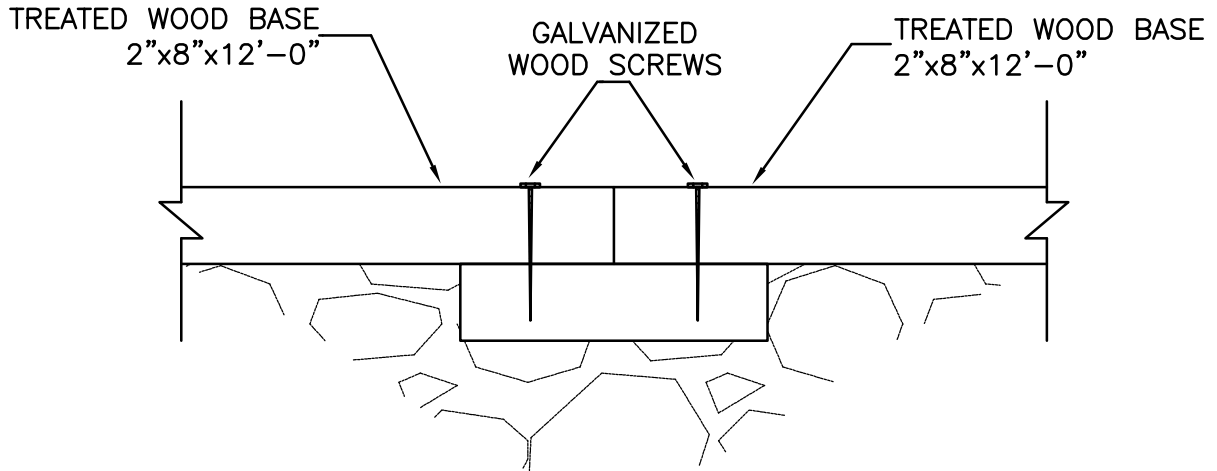

SIDE VIEW OF WOOD BASE

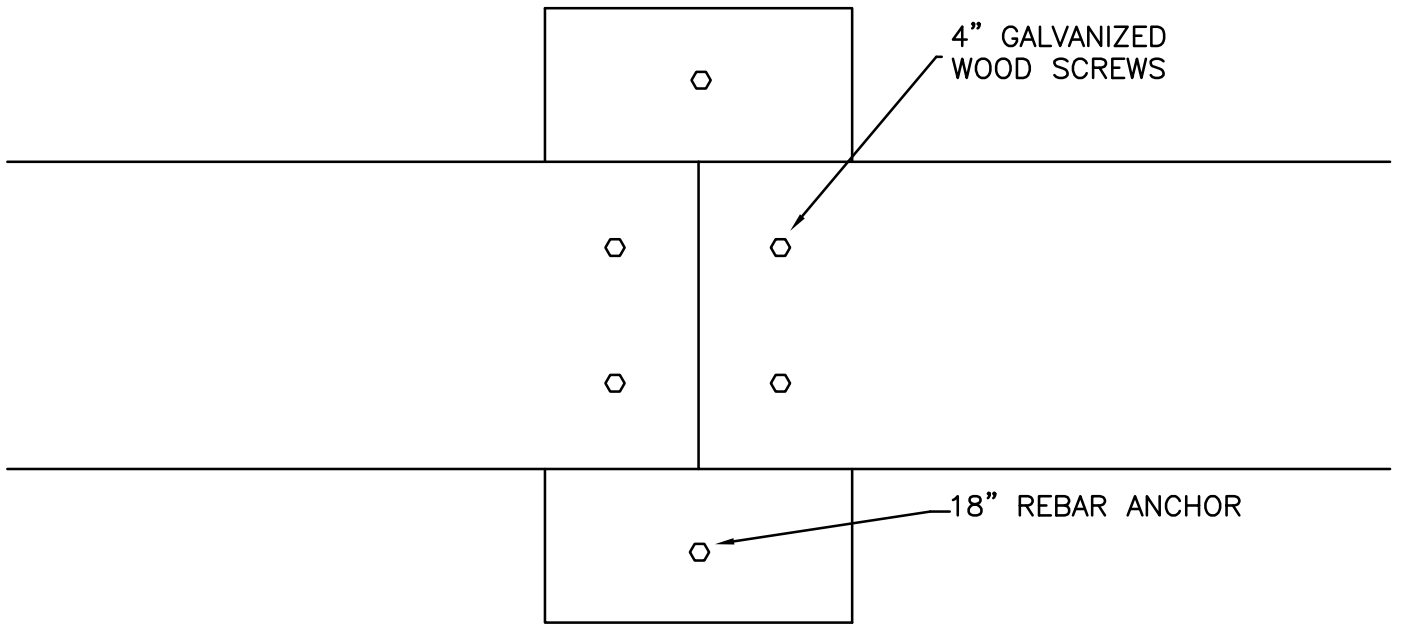

TOP VIEW OF WOOD BASE

RTS Canada Ltd.
Rubber Trails & Surfaces Canada Ltd.
815 Hwy 336 Upper Musquodoboit
Nova Scotia Canada B0N 2M0
Tel: (902) 568-2469
email steve.benison@ns.sympatico.ca

Artificial Sport Field Rubber Flex Curbs Installation Instructions

Wood Base:

NOTE: ALWAYS BE AWARE OF FINISHED CURB HEIGHT

REQUIREMENTS

A: Grade the outer perimeter of the sport field at least 2ft wider than the finished turf field requirements

B: Compact this material

C: Cut pieces of 2in x6in into 2ft pieces to use as cross supports

D: Using 18in re-bar with welded washers anchor the 2ft pieces at the end of the 16ft boards so that the two board ends are evenly supported on the 1 cross board. Anchor another cross board support approximately every 8ft. Lay the 16ft board on top of the cross supports. Using galvanized wood screws, screw top board into cross supports.

SEE Addendum # 1

E: When installing cross supports, remove a 6in wide by 1.5in deep trough of crusher dust. This will allow the cross supports to be flush with compacted crusher dust layer

SEE Addendum #2

F: Sight the level of all cross supports remembering that you will be adding another 2in x 6in board as well as the rubber curb on top of this height.

G: Start at one corner and cut rubber curb at a 45 degree angle, place a bead of glue on these ends and push together, using the 5in galvanized screws and stainless steel washer secure the rubber curb to the treated wood.

H: Place the first screw 3in from the joined end, place the next 3 screws approximately 2ft apart, and place the last screw 3in from the end of the curb. Put a bead of glue on the end and continue.

I: Push curbs firmly into one another when you are installing the fastener, this will make for a tight joint. Be sure to scrape away excess glue that may ooze out from the joined ends

J: When all the curbs have been installed and all excess glue has been removed you can now top coat the entire curb layout

K: Mix enough top coat to do approximately 1/3 of the total area to be covered, if you mix too much top coat at one time it may begin to set up before you can get it applied. Cover all parts of the curb (top and outside edge) that will be exposed to sunlight. Two coats are recommended.

SEE: top coat mixing instructions

L: You are now ready to backfill outer area (sod, asphalt, running track etc.)

M: Grade and compact infill material to the top of the inner lip of the rubber flex curb

N: Once this is completed you are ready to install artificial sport field carpet

GRAVEL BASE:

A: Follow steps A and B as indicated in wood base setup

B: Sight and stake the entire outside perimeter of the sport field layout. Keep in mind that the carpet edge will be 2.25in shorter than the outside of the curb.

C: Start the rubber flex curbs at one corner of the field to get the 90 degree angle set. Work out from this point.

D: Using the pre drilled holes in the curb base drive the supplied 18in anchors into the ground. Follow sight string line carefully so that the side of the finished curb is straight and not wavy

E: Put glue on both curb ends and push them tightly into each other, holding pressure on the curb start to drive the anchor into the ground, continue to install next anchor.

F: Follow steps I through N